

1. Before coming to Japan

1-1 How to find your accommodation or housing

Since there is currently no on-campus housing available at SFC, many SFC international students live in apartments or privately-owned student dormitories/halls located near campus. It is possible to apply to live in Keio University dormitories, but they are all located more than an hour away from SFC.

If you want to live near SFC, you will need to find an apartment or a privately-owned student dormitory/hall by yourself.

It is highly recommended that you start searching for housing information and contacting realtors or companies that own student dormitories/halls before coming to Japan.

Finding an apartment

There are several English-speaking realtors near Shonandai Station as listed below. Some of their websites are available only in Japanese, but they have staff members who can assist you in English.

If you want to obtain apartment information from the realtors listed below, please fill in the “Request Form for Housing Referral” and send it to the SFC Student Life Section via email. The SFC Student Life Section will forward the request form to all of realtors below, and you will be contacted by a realtor if there are apartments that satisfy your specifications. Alternatively, you may contact a realtor directly.

Please use the link below to download the “Request Form for Housing Referral.”

<http://www.gakuji.keio.ac.jp/en/sfc/sl/housing.html>

●List of realtors located near Shonandai Station

- Housemate – Shonandai branch
<http://www.housemate-navi.jp/shop/59>
Email: s-syonandai@housemate.co.jp
- Mini Mini – Shonandai branch
<http://minimini.jp/shop/10016/shonandai/index.html>
Contact: <https://minimini.jp/shop/10016/shonandai/contact/>
- Leoplace 21: For International Students
<http://en.leopalace21.com/students/> (English website available)
- ABLE: For International Students
<http://www.able.co.jp/international/> (English website available)
Email: ryugakusei@able.co.jp (English, Chinese and Korean available)

*In order to rent an apartment you have to bring your passport, residence card, and guarantor form (information about your guarantor) to the real estate agency.

*Please keep in mind that it can take up to one week until you can move into your new apartment.

*You can only share your apartment with another person if the real estate agency agrees to it.

Japanese Apartments

As you can see in the table below, Japanese apartments are categorized as “mansions” or “apartments.” If you are looking for accommodation in Japan, first decide which of type of apartment you want to live in. Furthermore, you will be confronted with terms like “*shikikin*” (deposit) or “*reikin*” (key money). Before moving in, you are usually required to pay a rental deposit, key money and a real estate commission. This essentially means that students need to prepare at least 4 months’ rent in advance to be able to move in. In the Tokyo area, accommodation tends to be quite expensive, so most students prefer to live in more affordable areas outside big cities.

	Japanese	English/Meaning
Housing Terms	敷金 <small>shikikin</small>	Deposit: The deposit is used to cover any damage to the apartment or any cleaning that is necessary when you leave. Some contracts may also stipulate whether you will get the deposit back in full or only receive a percentage of the deposit even if you have left the apartment in good condition.
	礼金 <small>reikin</small>	Key Money: To enter an apartment, the equivalent of usually 2 month’s rent may be necessary. The key money is non-refundable. It may be worth trying to negotiate on this point.
	マンション <small>manshon</small>	Mansion: A Japanese "mansion" (<i>manshon</i>) is a large, multiple-story (three or more usually) apartment or condo building made of reinforced concrete, steel or a combination of the two.
	アパート <small>apaato</small>	Apartment: An " <i>apaato</i> " is usually only two to three floors and made of wood or lightweight steel (which means sound carries more).
	和室 <small>washitsu</small>	Japanese-style rooms: The floor is covered with tatami mats and the windows may have shoji (paper screens) in place of curtains. Most washitsu have a built-in closet (oshiire). The floor area of washitsu is measured in tatami mats. The average size of a tatami mat is about 2m x 1m.

Japanese apartments are also described by different combinations of the letters “LDK” (L= Living room, D=Dining area, K= Kitchen) and/or in square meters. For example, a 2DK has two rooms and a dining kitchen, a 1K has one room and a small kitchen, a 3LDK has three rooms with a large combined living/dining/kitchen space. Some apartments are also described as “One Room.” Real estate agencies usually have apartment floor plans that show the layout of the apartment, including details on bathroom/toilet facilities and whether the rooms are western or Japanese-style.

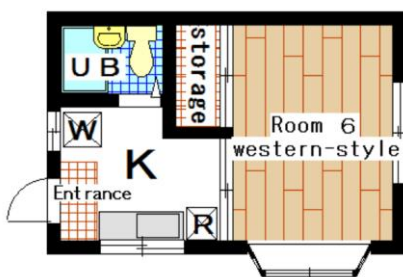

Example of a 1K room



Example of a 1LDK room

Finding student dormitories/hall (besides Keio University dormitories)

If you want to live in a student dormitory/hall near SFC (Shonandai, Chogo, Totsuka, Kozashibuya, Sagamiono, etc.), please contact Kyoritsu Maintenance for housing information. They will send you all the necessary information regarding available rooms close to SFC.

- Kyoritsu Maintenance: <http://www.gakuseikaikan.com/international/english/index.html>



Dormy ShonanFujisawa2
(co-ed): 5min to SFC by Bus



Dormy Shonandai Lei
(women only): 5min to Shonandai Station on foot



Dormy Shonandai (co-ed):
4 min to Shonandai Station on foot



Dormy Chogo (men only):
2 min to Shonandai Station by train



Dormy Yamato (men only):
4 min to Shonandai Station by train



Dormy Futamatagawa
(co-ed): 13 min to Shonandai Station by train



Dormy Higashi-Totsuka
(women only): 20 min to Shonandai Station by train



Dormy Machida
(women only): 20 min to Shonandai Station by train

- Link for another student dormitory/hall open to international students.

<http://www.kif-org.com/placehall/e04.html>

Living in Keio University dormitories

Please refer to the International Center website on the next page for information on applying to the Keio University dormitories.

Dormitory	Type	Address	Nearest Station
Shimoda Student Village	Dormitory, Single	Hiyoshihongo, Kohoku-ku, Yokohama, Kanagawa	13 min. walk from Hiyoshi Station, Toyoko Line
Plume IS	Dormitory, Single	Yagami, Saiwai-ku, Kawasaki, Kanagawa	12 min. walk from Shin-Kawasaki Station, Yokosuka Line
Omori Student Dormitory	Dormitory, Single	Omori Nishi, Ota-ku, Tokyo	15 min. walk from Kamata Station, Keihin-Tohoku Line or 12 min. walk from Umeiyashiki Station, Keikyu-honsen Line
Tsunashima Student Dormitory	Dormitory, Single	Tsunashima Nishi, Kohoku-ku, Yokohama, Kanagawa	7 min. walk from Tsunashima Station, Toyoko Line
Motosumiyoshi Residence	Dormitory, Single	Kizuki, Nakahara-ku, Kawasaki, Kanagawa	8 min. walk from Hiyoshi Station, Toyoko Line
Okurayama Dormitory	Dormitory, Single	Tarumachi, Kohoku-ku, Yokohama, Kanagawa	15min. walk from Tsunashima Station, Toyoko Line
Hiyoshi International Dormitory	Dormitory, Single (Unit type)	Hiyoshi, Kohoku-ku, Yokohama, Kanagawa	18 min. walk from Hiyoshi Station, Toyoko Line or 3 min. walk from "Hiyoshi go chome" bus stop after a 6 minute ride from Hiyoshi Station bus stop
Motosumiyoshi International Dormitory	Dormitory, Single	Kizuki, Nakahara-ku, Kawasaki, Kanagawa	8 min. walk from Motosumiyoshi Station, Toyoko / Meguro Line
Tsunashima SST International Dormitory	Dormitory, Single	Tsunashima Higashi, Kohoku-ku, Yokohama, Kanagawa	10 min. walk from Tsunashima Station, Toyoko Line



Since the number of available rooms in the University dormitories are limited, not all applicants may be accommodated. Also note that all University dormitories are more than an hour away from SFC and the allowed residence period is one year maximum.

●Keio University International Center: http://www.ic.keio.ac.jp/en/life/housing/ryu_boshu.html

Other accommodations

Besides living in a privately rented apartment or dormitory, house sharing or living in a so called “share house” is another option to consider. The basic concept of a share house is similar to sharing an apartment with someone in western countries. Several people live together in the same house or apartment and share common areas like the kitchen, living room and bathrooms, but mostly have some their own bedroom to use privately.

In contrast to other types of room sharing, share houses are managed by a management company and mostly have an administrator involved, so you have someone to go to with problems that you cannot or do not want to discuss with your roommates.

Depending on the house and the area, share houses can be furnished quite basically or luxuriously, which will also have an influence on the rent. Private rooms are often furnished with a bed, air conditioner, television, small fridge and desk and are most popular with students and working adults in their 20s and 30s, Japanese as well as foreigners. There is no average length of stay, since people might be living there for just one month or up to several years. Aside from the social aspects and emphasis on the community, a share house can be more budget-friendly, as they do not usually require high deposits, key money and/or other initial fees that many apartments in Japan demand. Plus, the costs for gas/electricity/water/internet will be shared by all residents and regulated by the management, so you do not have to apply for those services separately. In most cases you do not need a guarantor, but some “emergency contacts” in Japan instead.

Please inform yourself through the websites below:

- Tokyo Sharehouse: <http://tokyosharehouse.com/eng>
- Oakhouse: <http://www.oakhouse.jp/eng/>
- Sakura House: <http://www.sakura-house.com/en>
- Sharetomo Program: <http://www.sharetomo.jp/>

Please note that there is always the possibility of problems arising from sharing common spaces like the kitchen or living room with strangers. Please inform yourself of all housing possibilities, and choose your accommodation wisely.